

# Vermont ready to fit **DECKING**

**Built by craftsmen, assembled by you.**



## It's so clever

### NO SCREWS



In the construction of all Vermont panels the top decking boards are factory pre-fixed to the cross battens from beneath rather than from the face of the deck as in many traditional built decks. So even when you screw the top decking panel into place between the boards, no screws are visible from the top, giving a considerably more attractive finish. They are accessible, however, should you need to lift any deck panel.

### NO GROUNDWORK



With Vermont Ready to Fit Decking you level the deck not the ground, removing hours, possibly days of hard work. The Vermont system is suitable for relatively flat gardens, patio areas, etc.

The Vermont interlocking levelling Block and Wedge allows you to easily adjust the level of your deck up to a height range of 24cm.

### OBSTACLES NO PROBLEM



The simple use of decorative stones and potted plants give a really attractive finish to your deck and is a simple solution to filling awkward gaps around your house. Alternatively the Vermont filler bracket and board (12cm wide) can be used to complete a flush finish.

### NO RAILING ASSEMBLY



Vermont Rail Units are available in pre-assembled lengths, with Vermont assembly shoe already attached.

We do not recommend that you cut Vermont panels - single boards can be cut if necessary to fit in-fill situations

**CARE AND MAINTENANCE** Vermont Ready to Fit Decking is pressure treated to last at least 15 years. The decorative finish is achieved using Ronseal Decking Oil, Natural Cedar. This may require annual maintenance. We recommend the use of Ronseal Decking Cleaner plus Ronseal Decking Oil.

**WEBSITE** You can also plan your deck on our interactive website, [www.vermont.ie](http://www.vermont.ie).



# It's so easy

**Vermont** ready to fit  
**DECKING**

Vermont Ready To Fit Decking is a modular self-assembly decking system that allows even the most reluctant DIY'er to fit a professional quality deck with ease and in less than a day. It's so easy - all you need is a spanner, a screwdriver and a spirit level. All bolts and screws are included.

Vermont Ready To Fit Decking is produced using the highest quality Baltic Spruce, sourced from managed forests. It is pressure treated giving it at least 15 years protection and is coated with Ronseal Decking Oil, giving a beautiful decorative finish. All metal parts are galvanised, giving them 15 years protection also.



## Be creative

As this is a modular system, Vermont panels, including quadrant and triangle shapes allow complete design flexibility. You can extend your deck by adding more panels in the future if you wish.

All decks need to be assembled in a brickwork pattern for maximum strength.

Costs shown are based on Vermont recommended retail pricing.

**3mx3m**



Approx Cost\*  
**€860**

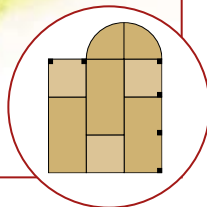

**4mx4m**



Approx Cost\*  
**€1,635**

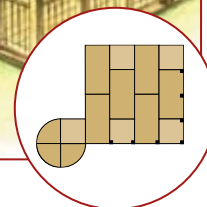

Each panel consists of 2 pieces



A subframe & A top deck panel

(The combined depth is 9cm)

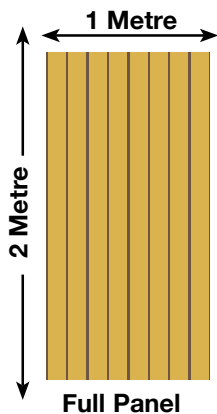

Full Panel

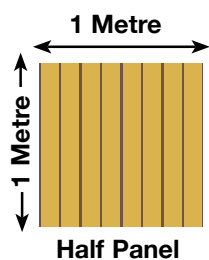

Half Panel

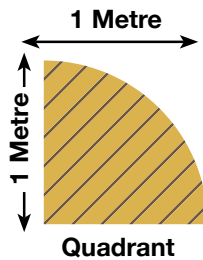

Quadrant

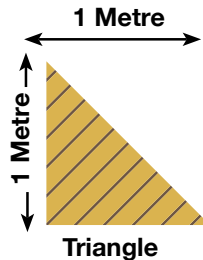

Triangle

0.37 metres

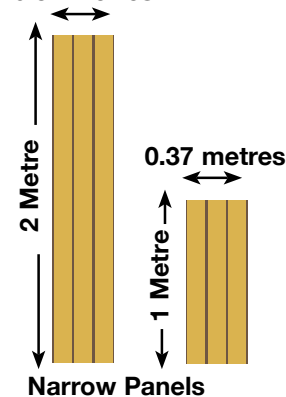

Narrow Panels

Vermont Ready to Fit Decking has two principle building blocks - a 2 metre x 1 metre panel and a 1 metre x 1 metre panel. These two panels allow you to build the deck of your choice using a brickwork pattern for maximum strength. The addition of the quadrant panel, triangular panel and narrow panels plus rail units allow you to be as creative as you wish in your deck design.

**3mx5m**



Approx Cost\*  
**€1,750**

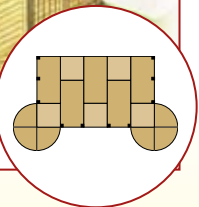

Approx Cost\*  
**€685**

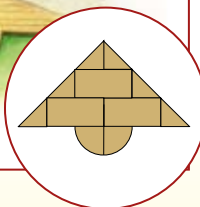
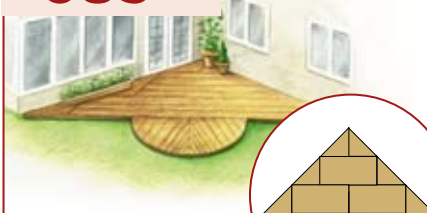

**7mx5m**



Approx Cost\*  
**€2,060**

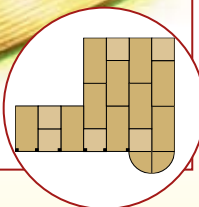

# A deck in a day

**Vermont** ready to fit **DECKING**



**Step 1**  
**Modular Layout**  
Plan your deck layout in a brickwork pattern using the Vermont panels



**Step 2**  
**Panels**  
Separate subframe from the top deck panel



**Step 3**  
**Subframe laid out**  
Place subframe in chosen position



**Step 4**  
**Bolting of subframe**  
Bolt subframe panels together



**Step 5**  
**Levelling the frame**  
Use the easy levelling Vermont Block & Wedge system



**Step 6**  
**Top panels being fixed**  
Slot top deck panels into place and screw to subframe



**Step 7**  
**Railing being placed**  
Fit pre-assembled rail units

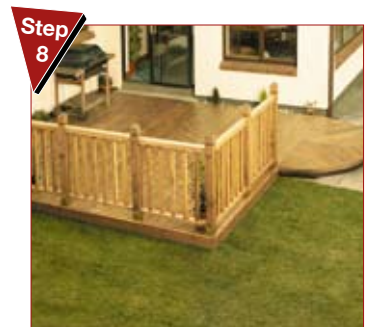

**Step 8**  
**Finished deck**  
Enjoy a job well done

## Vermont Deck Design Planner

**ASSISTANCE** If you need assistance calculating your requirements, you can fax your chosen design, making sure measurements are clearly marked and all obstacles are included to: **Fax 01 - 8079105**. We will calculate your requirements and send a return fax. You can also email your design details to [www.vermont@woodiesdiy.com](mailto:www.vermont@woodiesdiy.com). Alternatively, you can plan your deck online at [www.vermont.ie](http://www.vermont.ie)

**Full Panel**  
2m x 1m

**Half Panel**  
1m x 1m

**Triangle**  
1m x 1m

**Quadrant**  
1m x 1m

**Narrow Panels**

2m x .375m  1m x .375m  1m unit  90cm unit  Post

**Rail units**

Single decking boards 2m  1m

Infill bracket packs (2 per pack)

Levelling block packs (10 per pack)

1 Metre

1 Metre

# Planning and measuring your deck

## Choosing the right site

The first step is to decide the shape and location of your deck.

- Consider the size you want the deck to be
- It is not necessary to physically attach the deck to the house or wall.

## In all situations observe the following:

- Choose a firm, relatively flat area
- Choose an area with easy, safe access
- Choose a well drained area

**Using the Planner** - Measure the area you wish your deck to cover and draw the shape into the metric grid. If the deck is adjacent to a house it may be easier to start by drawing the shape of the house. Make sure to include obstacles such as drainpipes. Begin drawing out your deck, starting at the outer edges of these obstacles. Any gaps are easily filled with decorative stone, bark, planting or using the Vermont infill brackets.

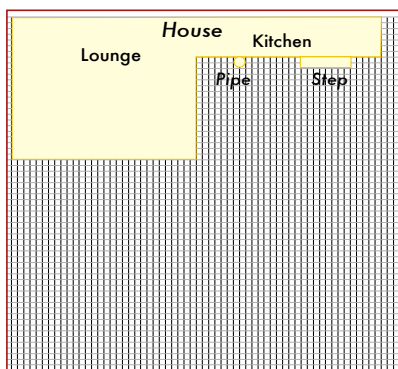

Start by drawing an outline of the area including any obstacles such as steps or pipes.

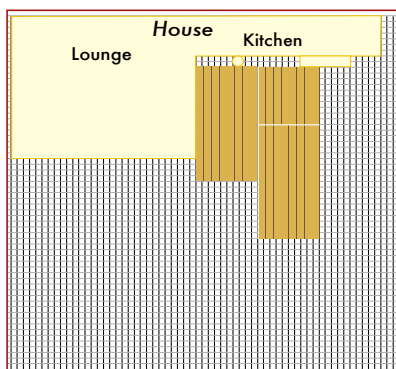

Build up your design by drawing in the panel shapes in a brickwork pattern alternating full and half panels. Start from the edge of any obstacles working outwards.

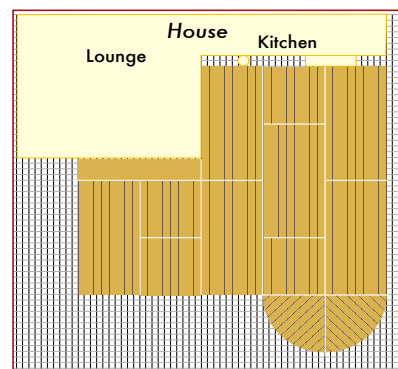

Complete your design and plan rail units if required (see below).

## Planning your railings

Our ready assembled rail units make the job of calculating what you need into a simple matter. For each metre of rail you wish to install you need a 1 metre unit.

At the end of a straight run of rails you have to finish with a 90cm rail and newel post. The slighter shorter rail is designed to leave room to fit the post on the panel.

The rails on our system can be fitted at right angles to one another to make a 90 degree turn as shown. When making a turn start the second line with a 1 metre unit and finish the line with a 90cm unit.



1 metre unit



90cm unit



Newel Post

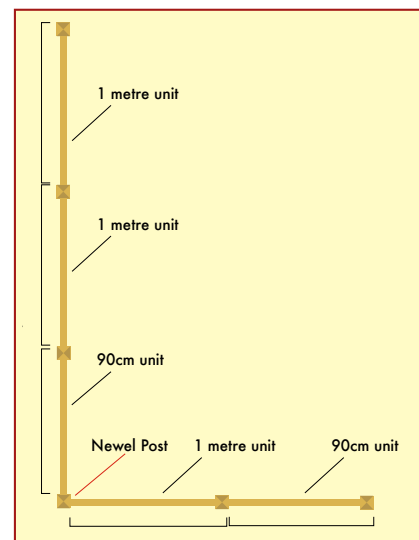

## The levelling system

Your requirements here will vary depending on the slope of your garden. The maximum recommended height Vermont levelling blocks can be raised off the ground is 24cm (6 blocks high).

You will need to support the frame at each point where two or more subframes join and along the outer edges of the deck. As a guide you will require a pack of 10 Blocks and Wedges for every 6 square metres of deck. The total number you need will depend on how sloped your garden is.

## Starting and Finishing

**Starting:** If laying your deck on grass it is recommended that you cover the grass with weed control fabric (not supplied). This is only necessary over grass or soil.  
**Finishing:** Use the Vermont single board as a fascia around your deck (available in 2 metre and 1 metre lengths). Trim a piece of weed control fabric around the base and screw the Vermont single boards around the fascia. Remember to calculate the length of the perimeter and include these single boards in your order. 40mm x 4mm galvanised wood screws are also required (one for every 50cm).

Part No	Product Name	Qty per Pack	Price (Inc VAT)
001	Vermont Decking 2x1m Large Panel	303763	1 €125.00
002	Vermont Decking 1x1m Small Panel	303765	1 €75.00
003	Vermont Decking 2mx375mm Narrow Panel	303766	1 €50.00
004	Vermont Decking 1mx375mm Narrow Panel	303767	1 €35.00
005	Vermont Decking 1x1m Quadrant	303768	1 €50.00
006	Vermont Decking 1x1m Triangle	303769	1 €35.00
007	Vermont Decking Single 2m Board	303770	1 €8.50
008	Vermont Decking Single 1m Board	303771	1 €3.00
009	Vermont Decking Block and Wedge (10 of each per pack)	303772	10 €25.00
010	Vermont Decking 100cm rail (inc metal shoe)	303773	1 €60.00
011	Vermont Decking 90cm rail (inc metal shoe)	303774	1 €50.00
012	Vermont Decking Newel Post (inc metal shoe)	303775	1 €20.00
013	Vermont Infill Bracket	303776	2 €6.00

\*Prices as per 28/05/09 and are subject to change.

Each panel consists of a pre-assembled subframe and top decking panel. All bolts and nuts are supplied with each part with the exception of single boards. Prices are effective until further notice.

Vermont Helpline: 1850 60 30 80 Website: [www.vermont.ie](http://www.vermont.ie)